

# VPC's **HIGH POWER** SOLUTION

VPC has developed a new High Power contact that reaches up to 150 Amps for your high current applications. Our High Power solution offers 360° of contact with low insertion force for quick and easy connections. High Power solutions are available in contacts and patchcords, which can be used in our iCon, i1, and 90 series products.

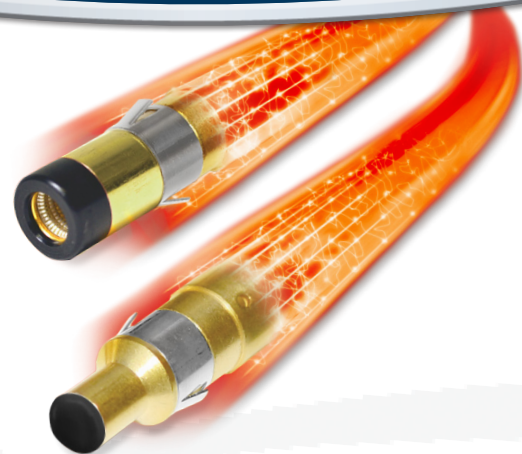

## FEATURES AND BENEFITS

- Multiple points provide 360° of contact with low insertion force
- Contacts are IP rated 2X when fully assembled
- Designed with Cooner 2 AWG wire\* for a flexible, reliable solution
- Contacts are gold-plated for signal integrity and reliability
- Available TriPaddle signal contacts enable a customer-wired safety interlock
- Contacts rated up to 10,000 cycles

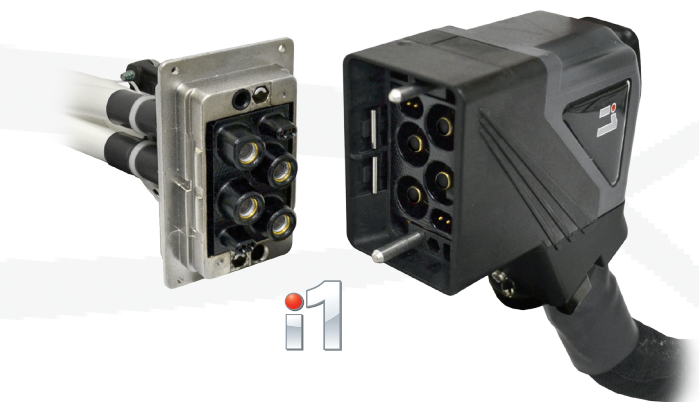

i1

Our i1 and iCon connectors accommodate four or six High Power contacts, respectively, to meet your high amperage needs. We also offer i1 and iCon solutions in flying lead configurations which allow Pin Your Own Configuration flexibility. Explore our High Power options online, [vpc.com/highpower](http://vpc.com/highpower).



iCon

## High Power Contacts ▼

### Specifications

Operating Current	150 Amp Continuous using 2 AWG wire
Contact Resistance	0.35 mOhms
Mating Force	2.5 lbs Max [1.13 Kg]
Operating Voltage	600V
Contact Body Receiver	Cu Alloy Internal Contact Beams - Cu Alloy
Contact Body ITA	Cu Alloy IP Tip - Thermoplastic
Contact Plating Receiver	Body - 10 $\mu$ " Au over 100 $\mu$ " Ni Internal Contact Beams - 60 $\mu$ " Ag over 50 $\mu$ " Ni
Contact Plating ITA	Body - 30 $\mu$ " Au over 100 $\mu$ " Ni
Operating Temperature	-40°C to 125°C
T-Rise	+35°C at 150 Amps
Contact Termination	Crimp
Cycle Life	10,000



Receiver Contact, Part # 610 149 101

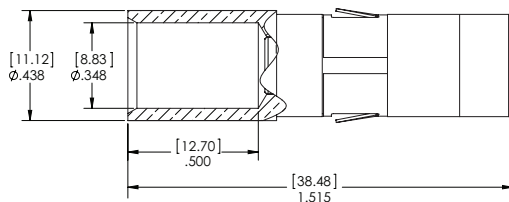

ITA Contact, Part # 610 150 101

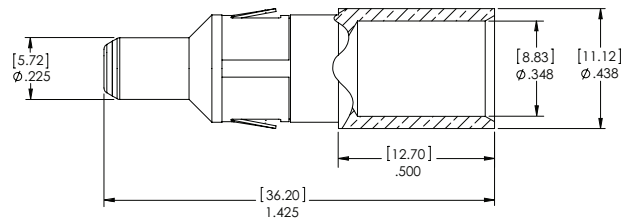

### Part #

### Description

610 149 101*	High Power Contact, Receiver, 150 Amps, 2 AWG
610 150 101*	High Power Contact, ITA, 150 Amps, 2 AWG, 30 $\mu$ " Gold
7-221 902 000-036*	High Power Patchcord, Receiver, 150 Amps, 36", 2 AWG, Single Ended
7-222 902 000-036*	High Power Patchcord, ITA, 150 Amps, 36", 2 AWG, Single Ended
510 104 307	TriPaddle Signal/High Power Module, Receiver, 6/6 Position, Strain Relief Plate Included
510 108 281	TriPaddle Signal/High Power Module, ITA, 6/6 Position
510 160 124**	TriPaddle Signal/High Power Module, Receiver, iCon, 4/4 Position
510 161 124**	TriPaddle Signal/High Power Module, ITA, iCon, 4/4 Position
510 109 549	Strain Relief Plate for High Power Standard/90 Series ITA and Receiver Modules
910 102 116	Tool, Crimp Kit (Pneumatic Crimp Tool, Locator and Die), High Power, Receiver and ITA
910 102 117	Tool, Crimp Kit (Locator and Die), High Power, Receiver and ITA
910 112 129	Tool, Extraction, High Power, Receiver and ITA

\*Tested and designed to use with [Cooner Wire CW6044-14\(UL Rated\)](#), [AS 105-14\(Non-UL\)](#), or equivalent.

\*\*Some physical limitations may apply and additional parts may be needed, please consult VPC for assistance in maximizing your system's performance.

For multiple conductor correction factors please reference <http://www.coonerwire.com/amp-chart/>.